

PL4014

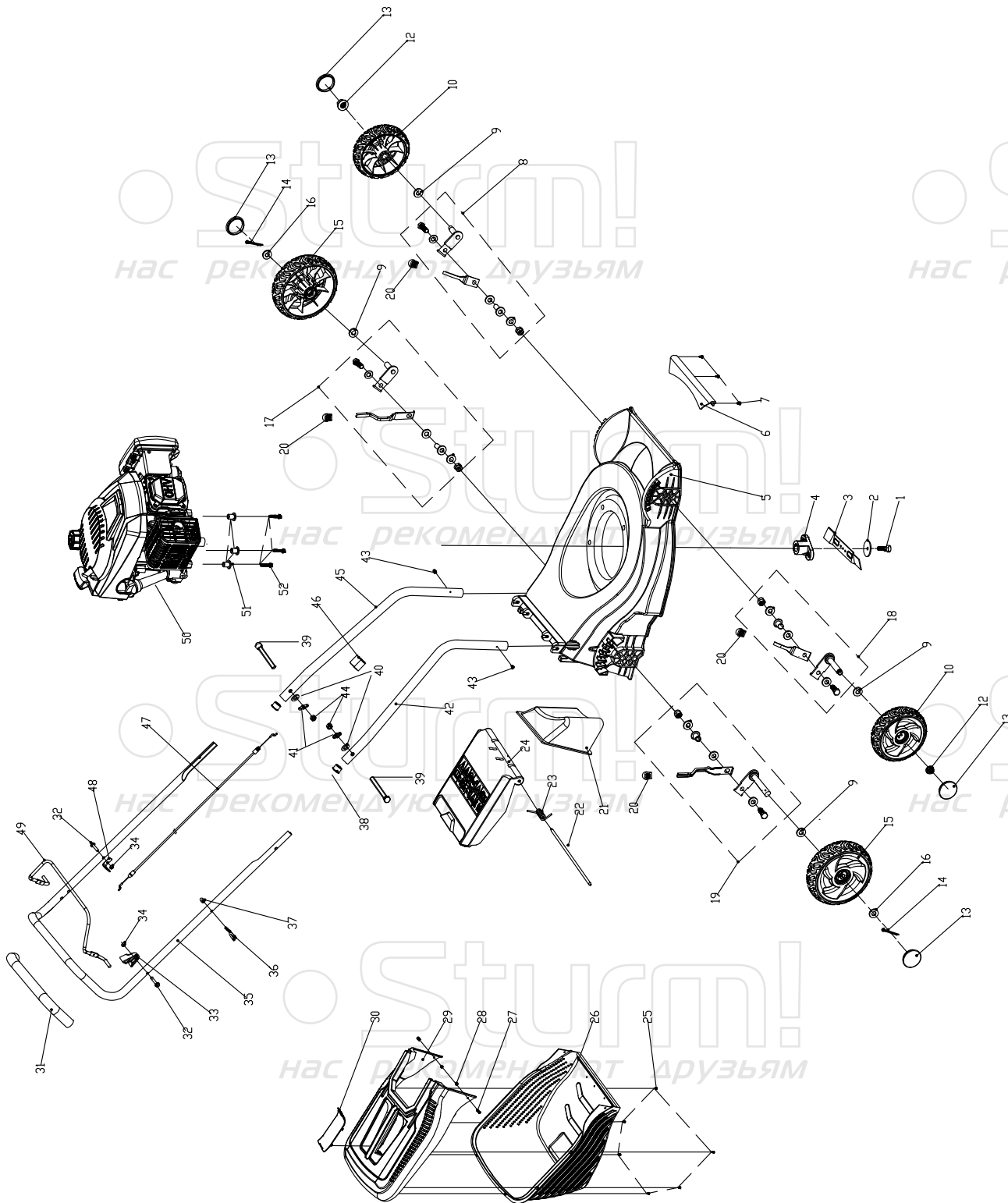

NO.	DESCRIPTION
1	blade bolt
2	blade washer
3	blade
4	Blade Adapter Assy
5	deck
6	front protection board
7	Screw ST4.2X12
8	front wheel height adjust handle assy.
9	Resilient washer $\phi 14.2 \times \phi 20.7 \times 0.5$
10	wheel assy.
12	Nut M10
13	outer cover of hub
14	R type pin
15	wheel assy.
16	Small washer $\phi 13 \times \phi 20 \times 1.5$
17	rear wheel height adjust handle assy.
18	front wheel height adjust handle assy.
19	rear wheel height adjust handle assy.
20	sheath of height adjustment handle
21	mulching plug
22	Rear discharge cover shaft
23	cover spring
24	rear discharge cover
25	screw ST3.5X18
26	Catcher bottom
27	Screw M5X10
28	Cap nut M5
29	Catcher Top
30	Catcher Top protection board
31	foam pipe
32	Bolt M6x30
33	lever guard
34	Nut M6
35	upper handle
36	Rope Guide
37	Cap nut M6
38	handle block
39	Bolt M8x50
40	flat washer $\phi 8 \times \phi 16 \times 2$
41	flat knob
42	lower handle
43	Screw ST4.2X17
44	Nut M8
45	lower handle
46	Cable clip
47	brake cable
48	Cable fix base
49	Brake lever
50	petrol engine
51	Chassis bushing
52	Bolt M8x40

Sturm!
нас рекомендуют друзья

Sturm!
нас рекомендуют друзья

ENGINE FOR PL4014

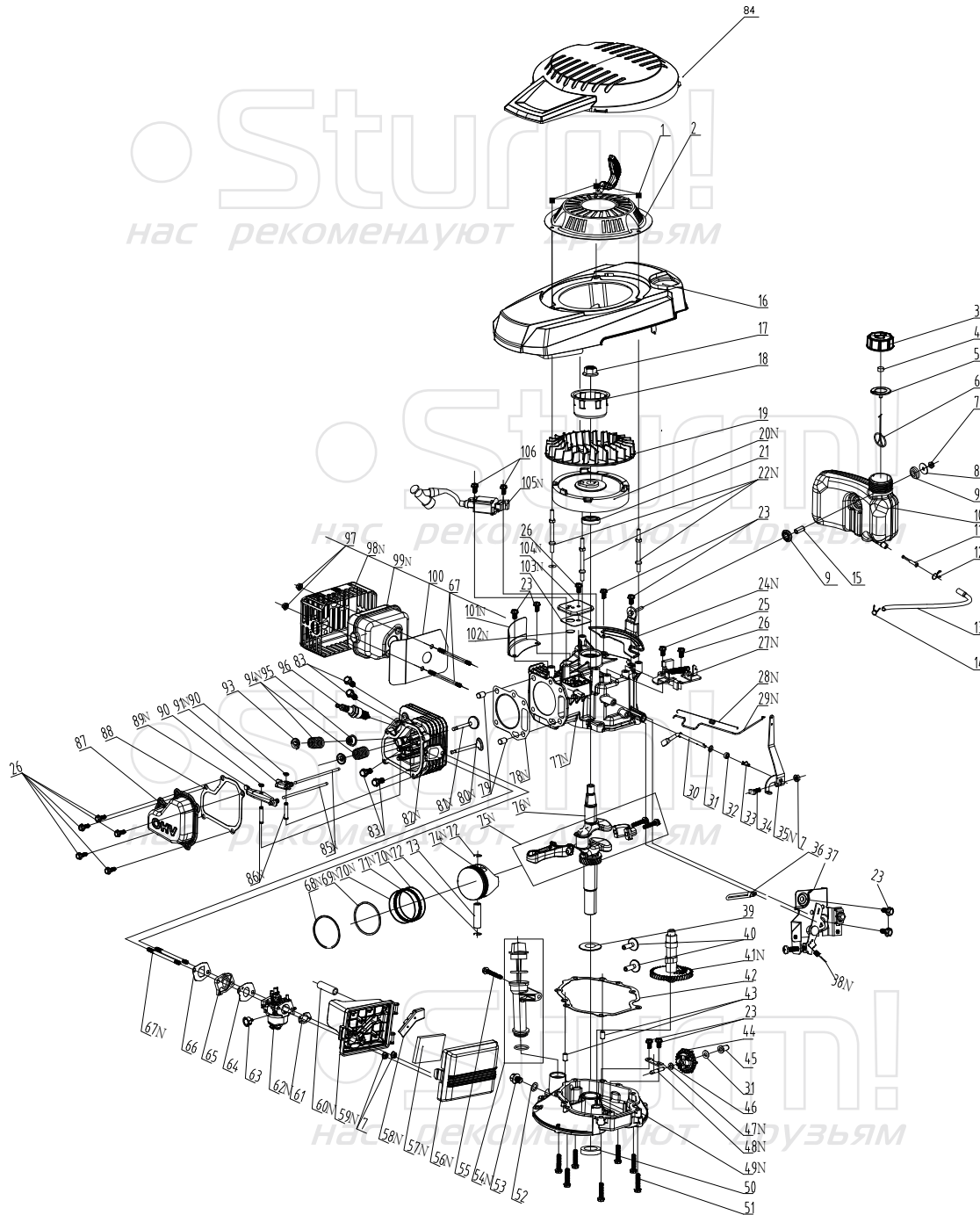

NO.	DESCRIPTION	NO.	DESCRIPTION	NO.	DESCRIPTION
1	Cap nut	36	clip	71N	Bushing Ring
2	pull starter assy.	37	throttle assy.	72	piston pin
3	fuel tank cap	38N	throttle control spring	73	Piston Pin circlip
4	fuel tank cap sponge	39	clockwise gear gasket	74N	Piston
5	Fuel Tank Cap seal gasket	40	pin	75N	connecting rod assy.
6	connect cable of fuel cap	41N	camshaft assy.	76N	crankshaft assy.
7	Hex flange nuts	42	Respirator head gasket	77N	crankshaft box assy.
8	The oil tank mount big washer	43	spacing pin	78N	Cylinder head gasket
9	Tank damping rubber pad	44	rete-limiting gear assy.	79	spacing pin
10	fuel tank body	45	Sliding Sleeve	80N	Intake Valve
11	Filtering Net Duct of Fuel	46	Gasket	81N	Exhaust Valve
12	fuel pipe lock clamp I	47N	rate-limiting gear shaft clamp	82N	cylinder head assy.
13	fuel pipe	48N	rate-limiting gear shaft	83	locking bolt
14	fuel pipe lock clamp II	49N	Crank box cover	84	engine cover
15	Fuel tank mounting bushing	50	oil seal	85N	push rod
16	The transparent cover	51	Bolt	86N	Valve rocker shaft
17	Hex flange nuts	52	Oil drain bolt gasket	87	cylinder head cover
18	starter hub	53	Oil drain bolt	88	Cylinder head gasket
19	fan	54N	Lubricating Gauge Assy	89N	Exhaust valve rocker combination
20N	flywheel assy	55	Bolt	90	washer
21	oil seal	56N	Air Filter Cover	91N	Air intake door rocker combination
22N	Dual-head bolts	57N	Foam filter	93	Spring Coil of Intake Valve
23	Bolt	58N	Vent groove cover plate	94N	valve spring
24N	main bracket of fuel tank	59N	An air filter base.	95	oil seal assy
25	Bolt	60N	waste pipe	96	spark plug
26	Bolt	61	Air filter paper pad	97	Self-locking nut
27N	detent assy.	62N	Carburetor	98N	muffler cover assy.
28N	Pull Spring for Pull Rod	63	prime button II	99N	muffler assy.
29N	Handspike of Valve	64	Carburetor paper pad II	100	Muffler insulating pad
30	rate-limiting rocker arm shaft	65	Air Inlet Pipe	101N	wind shield
31	Gasket	66	Carburetor paper pad I	102N	Respirator valve plate
32	oil seal	67N	Dual-head bolts	103N	Respirator head gasket
33	R type pin	68N	Piston Ring I	104N	Valve rocker shaft
34	bolt	69N	Piston Ring II	105N	Ignition assy.
35N	throttle rocker arm	70N	Guide Rail	106	Bolt

PL4014-EX-20220712

Sturm!
нас рекомендуют друзья